

Spot Lights HLV2 series

Refer to our website for product details.

CCS HLV2

Search



You can also use your smartphone or cell phone.

Use a search engine.

Provides high output spot lighting using an original optical design



HLV2-22

HLV2-22-1220-3W

HLV2-14/HLV2-14-HU

HLV2-22-3W

Applications

As a light source for a telecentric lens, light source for alignment of LCDs or circuit boards, light source for dimension measuring, and light source for spot illumination, etc.

Lineup with selection to match your needs

The HLV2 series provides a selection to match your usage environment and application. The LED color has a lineup of red, white, blue, and green.

HLV-14 series, with a lightweight and compact design

Compact model

The HLV2-14 series is perfect for saving space, with its lightweight and compact design.

Example connection with the lens



Weights just
18g



Spot Lights that achieve high output

The lightweight and compact Spot Light achieved high output through its unique optical design.

HLV2-22-3W series, a high output model

Standard model

HLV2-22 series



HLV2-22SW



Amount of light: 35% intensity
Shutter speed: 1/20,000 sec

High output model

The HLV2-22-3W series is a Spot Light with the highest output of all series.



HLV2-22SW-3W



Amount of light: 35% intensity
Shutter speed: 1/20,000 sec

* Brightness varies based on the camera's spectral sensitivity.

* The data included is for reference only and does not guarantee the quality of this product.

Custom orders

Please contact your CCS sales representative.

E.g.: Changed the LED emitted wavelength to infrared

Customizable items

- External/Internal diameter
- Wavelength/color
- Increase output
- Cable length
- Illuminating angle
- Format/material
- Connector format
- Installation/mounting

Wavelength



Created an Infrared Light

Etc.

Example configuration

Revised the optical system to increase the emitting efficiency for this high output Spot Light.

HLV2 series

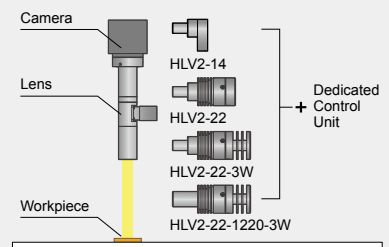

We have various materials.

PDF Drawings

DXF Drawings

3D CAD

Instruction Guides

Product Filers

Imaging Samples

Data Sheets

Examples of Custom Ordered Products

Download here.

<http://www.ccs-grp.com/dl/>

LDR2	Direct Lighting	
LDR2-LA		
LDR-LA1		
SQR		
SQR-TP		
HLDR-IP	Convergent Lighting	
HPR2	Diffused Lighting	
HPR		
LFR		
LKR		
FPR		
FPQ2	Direct Lighting	
LDL2		
LDLB		
HLDL2		
TH		
LFL	Diffused Lighting	
HPD2		
HPD		
LDM2		
LAV		
PDM	Collimated Lighting	
LFX2		
LFV3		
LFV2		
MSU		
MFU	Ultraviolet Lighting	
UV2		
UV		
LNSP-UV-FN		
IR2		
HLV2	Spot Lighting, Etc.	
LV		
LSP		
HFS/HFR		
HLV2-NR		
HLV2-3M-RGB-3W		
PFB2		
PFB		
LNSP		Convergent Lighting
CU-LNSP		
LNSP-FN		
LN/LN-HK		
LNSD		
LND2	Diffused Lighting	
HLND		
LT		
LNW/HLND		
LNIS		
LNIS-FN	Oblique Angled Lighting	
Telecentric Lens		
Macro Lens		

➤ Lineup offering a selection to match your needs

■ HLV2 series evaluation chart

	Brightness	Uniformity	Lightweight design	Compact design	Flexibility for installation	Energy savings
HLV2-14 [Standard type]	Good	Good	Very Good	Very Good	Good	Very Good
HLV2-14-HU [Uniform type]	OK	Very Good	Very Good	Very Good	Good	Very Good
HLV2-22 (Comparison criterion)	Good	Good	Good	Good	Good	Good
HLV2-22-3W	Very Good	Good	OK	OK	Very Good	Good
HLV2-22-1220-3W	Very Good	Good	OK	OK	Very Good	Good

■ HLV2 series evaluation graph

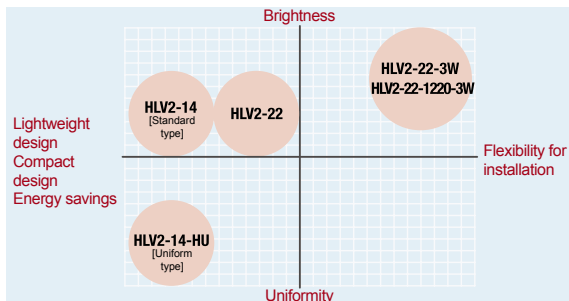

* Comparison using CCS products

➤ Imaging example: Imaging of 2-dimensional code



Description	Code reading
Workpiece	2-dimensional code
After the proposal	HLV2-22RD-3W

■ HLV2-22RD-3W

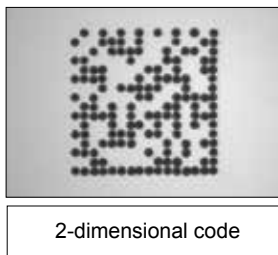

➤ Imaging example : Imaging of an alignment mark



Description	Positioning
Workpiece	Alignment mark
Light Unit in use	HLV2-22SW-3W

■ HLV2-22SW-3W

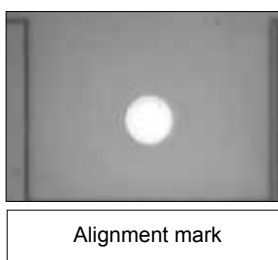

Direct Lighting	LDR2 LDR2-LA LDR-LA1 SQR SQR-TP		
Convergent Lighting	HLDR-IP		
Diffused Lighting	HPR2 HPR LFR LKR FPR FPQ2		
	Direct Lighting	LDL2 LDLB HLDL2	
	Diffused Lighting	TH LFL HPD2 HPD LDM2 LAV PDM LFX2 LFX3 LFX2	
		Collimated Lighting	MSU MFU
Ultraviolet Lighting		UV2 UV LNSP-UV-FN	
Infrared Lighting		IR2	
Spot Lighting, Etc.		HLV2 LV LSP HFS/HFR HLV2-NR HLV2-3M-RGB-3W PFB2 PFBR	
		Convergent Lighting	LNSP CU-LNSP LNSP-FN LN/LN-HK
			Diffused Lighting
	Oblique Angled Lighting		
		Lenses	

HLV2 series



Refer to our website for product details.

CCS HLV2

Search



You can also use your smartphone or cell phone.

Use a search engine.

Comparison of data for the HLV2-14 series

Brightness comparison between the HLV2-14 and HLV2-14-HU

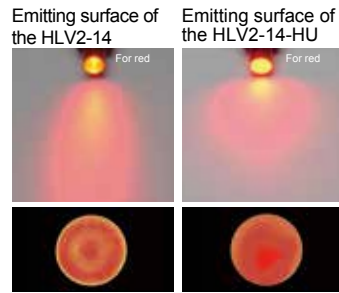
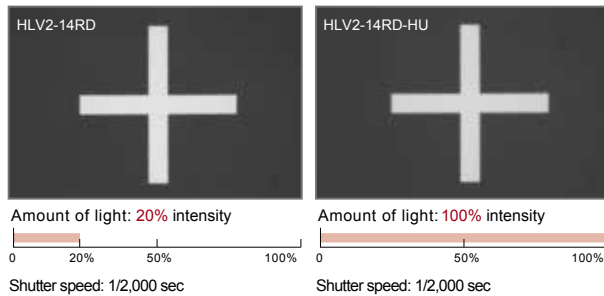

The HLV2-14-HU is a Spot Light with a highly uniform emitting surface.

* Comparison using CCS products
* This data is for reference only.
(This does not guarantee product quality.)

Lineup

Model name	LED color	Power consumption	Peak wavelength/ correlated color temperature	Options	Recommended Control Units	Weight
HLV2-14RD	Red	0.9 W	645 nm	-	<input type="checkbox"/> PD3* <input type="checkbox"/> CC-PJ-0707 <input type="checkbox"/> PJ	18 g
HLV2-14SW	White		5,300 K			
HLV2-14BL	Blue		465 nm			
HLV2-14GR	Green		520 nm			
HLV2-14RD-HU	Red	0.9 W	645 nm	-	<input type="checkbox"/> PD3* <input type="checkbox"/> CC-PJ-0707 <input type="checkbox"/> PJ	18 g
HLV2-14SW-HU	White		4,700 K			
HLV2-14BL-HU	Blue		465 nm			
HLV2-14GR-HU	Green		520 nm			
HLV2-22RD	Red	1.4 W	645 nm	<input type="checkbox"/> Convergent lens	<input type="checkbox"/> PD3* <input type="checkbox"/> CC-PJ-0707 <input type="checkbox"/> PJ	37 g
HLV2-22SW	White		5,300 K			
HLV2-22BL	Blue		465 nm			
HLV2-22GR	Green		520 nm			
HLV2-22RD-3W	Red	2.8 W	645 nm	<input type="checkbox"/> Convergent lens	<input type="checkbox"/> PD3* <input type="checkbox"/> CC-PJ-0707 <input type="checkbox"/> PJ	41g
HLV2-22SW-3W	White		5,300 K			
HLV2-22BL-3W	Blue		465 nm			
HLV2-22GR-3W	Green		520 nm			
HLV2-22RD-1220-3W	Red	2.8 W	645 nm	-	<input type="checkbox"/> PD3* <input type="checkbox"/> CC-PJ-0707 <input type="checkbox"/> PJ	42 g
HLV2-22SW-1220-3W	White		5,300 K			
HLV2-22BL-1220-3W	Blue		465 nm			
HLV2-22GR-1220-3W	Green		520 nm			

Extension Cables ▶ P.222

Control Unit Selection Guide ▶ P.181

Control Unit Page ▶ P.185

* The PD3-3024-3 and PD3-5024-3 series are not applicable to these products.

Caution

- The length of the extension cable must be 5 m or less. If you would like to use longer than 5 m, please contact your CCS sales representative.
- Branch cables cannot be used. Use the FCB series (straight cable) or the FRCB series (robot cable).

LED properties

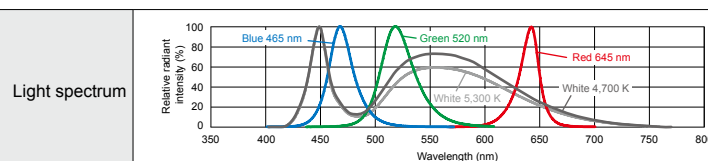

If using a sharp-cut filter, please use the R60 (option). For details about the sharp-cut filter, refer to P.215.

Be sure to read the "Instruction Guide" included with the product before use and observe cautionary information. The data included is for reference only and does not guarantee the quality of this product.

We have various materials.

PDF Drawings

DXF Drawings

3D CAD

Instruction Guides

Product Filers

Imaging Samples

Data Sheets

Examples of Custom Ordered Products

Download here.

<http://www.ccs-grp.com/dl/>

LDR2	Direct Lighting
LDR2-LA	
LDR-LA1	
SQR	
SQR-TP	Convergent Lighting
HLDR-IP	
HPR2	Diffused Lighting
HPR	
LFR	
LKR	
FPR	
FPQ2	Direct Lighting
LDL2	
LDLB	
HLDL2	
TH	Diffused Lighting
LFL	
HPD2	
HPD	
LDM2	
LAV	
PDM	
LFX2	
LFV3	
LFV2	
MSU	Collimated Lighting
MFU	
UV2	
UV	Ultraviolet Lighting
LNSP-UV-FN	
IR2	Infrared Lighting
HLV2	
LV	
LSP	
HFS/HFR	Spot Lighting, Etc.
HLV2-NR	
HLV2-3M-RGB-3W	Convergent Lighting
PFB2	
PFBR	
LNSP	
CU-LNSP	Convergent Lighting
LNSP-FN	
LN/LN-HK	Diffused Lighting
LNSD	
LND2	
HLND	
LT	
LNW/HLDN	Collimated/ Angled Lighting
LNIS	
LNIS-FN	Lenses
Telecentric Lens	
Macro Lens	

Dimensions (mm)

HLV2-14RD/SW/BL/GR/RD-HU/SW-HU/BL-HU/GR-HU

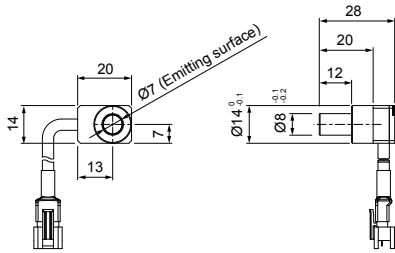

HLV2-22RD/SW/BL/GR

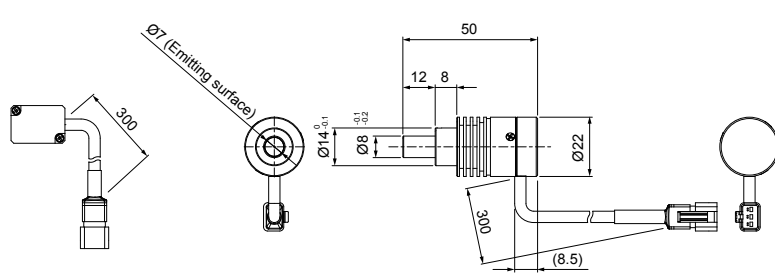

HLV2-22RD-3W/SW-3W/BL-3W/GR-3W

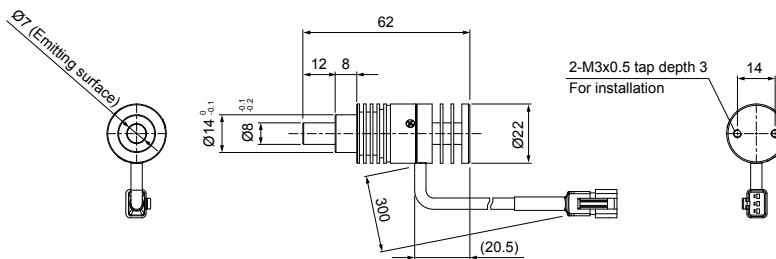

HLV2-22RD-1220-3W/SW-1220-3W/BL-1220-3W/GR-1220-3W

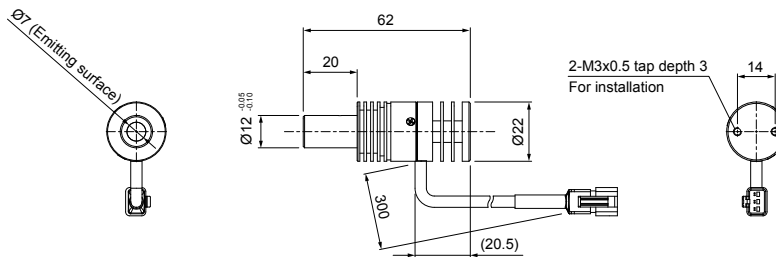

Options

HLV2-22 series dedicated convergent lens HL-30/HL-24-21



* Cannot be used with the HLV2-14/HLV2-22-1220-3W/HLV2-22-NR-3W series.

■ Illuminated range of the HL-30/HL-24-21

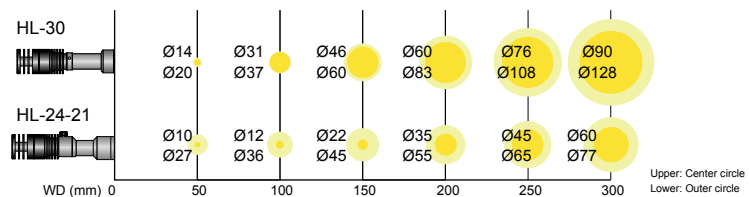

* This data is actual measurement values. (This does not guarantee product quality.)

■ Installation with the HLV2-22 series

Dimensions (mm)

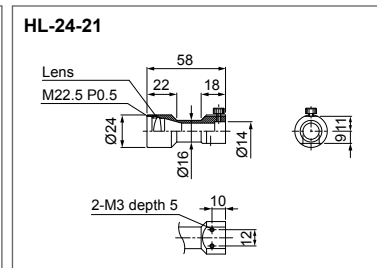
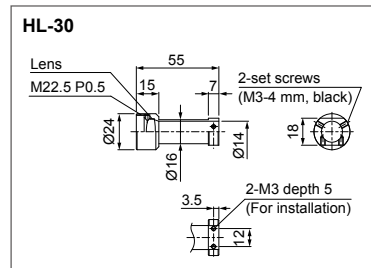
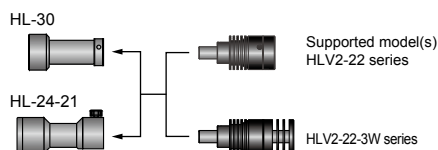

Direct Lighting	LDR2 LDR2-LA LDR-LA1 SQR SQR-TP
Convergent Lighting	HLDL-IP
Diffused Lighting	HPR2 HPR LFR LKR FPR FPQ2
Direct Lighting	LDL2 LDLB HLDL2
Diffused Lighting	TH LFL HPD2 HPD LDM2 LAV PDM LFX2 LFV3 LFV2
Colimated Lighting	MSU MFU
Ultraviolet Lighting	UV2 UV LNSP-UV-FN
Infrared Lighting	IR2
Spot Lighting, Etc.	HLV2 LV LSP HFS/HFR HLV2-NR HLV2-3M-RGB-3W PFB2 PFBR
Convergent Lighting	LNSP CU-LNSP LNSP-FN LN/LN-HK
Diffused Lighting	LNSD LND2 HLND LT LNV/HLDN
Oblique Angled Lighting	LNIS
Lenses	LNIS-FN Telecentric Lens Macro Lens