

# TEC-V05110MPW WI

**Magnification 0.5X, WD110mm  
for 1 inch type Cameras, 5 Megapixel Telecentric Lens  
C-Mount, Straight type with Manual Iris**

**with Manual Iris**

Model No.	TEC-V05110MPW WI		NA	0.027
Magnification	0.5X	TV Distortion	1 type	0.012%
Working Distance	110.2mm	Back Focal Length	17.0mm	
Effective F Number	9.0-32	Flange Back Length	17.526mm	
Max. Image Format	φ 16mm	Mount	C-Mount	
Control	Iris	Manual	Filter Size	-
	Focus	-		
Field of View	25.6mm(H) x 19.2mm(V) 1"		Dimensions	φ 48mm x 142.8mm
Resolving Power	12.0μm	Weight	215.8g	
Depth of Field	2.88mm	Operating Temperature	-10°C - +50°C	

**Dimensions**

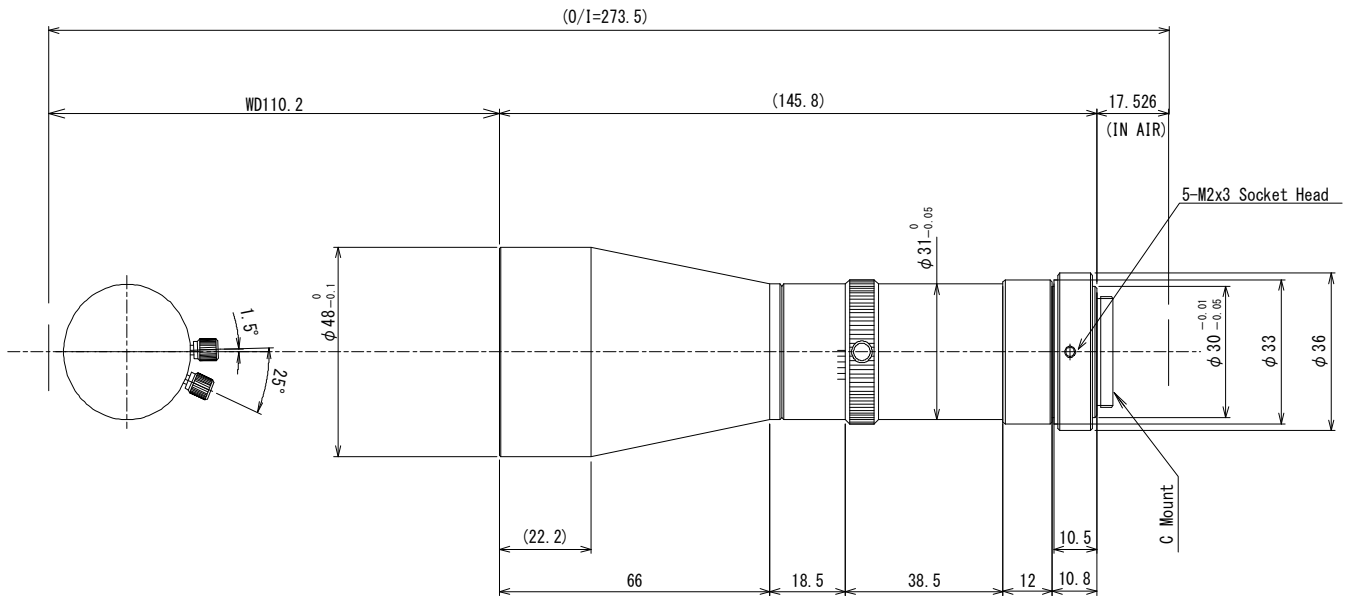

**Field of View at Sensor Size**

Format	Field of View(HxV)
1"	25.6 x 19.2mm
2/3"	17.6 x 13.2mm
1/1.8"	14.4 x 10.8mm
1/2"	12.8 x 9.6mm